

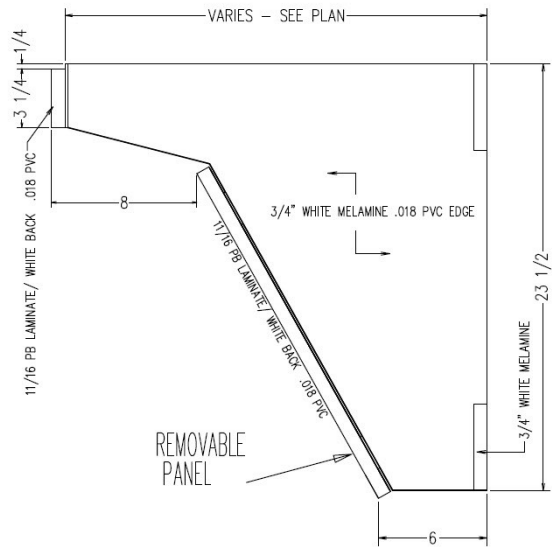

ADA SINK



ADA SINK with removable panel



TYPICAL ADASINK

Laminate cabinets are available in a wide range of standard features and options. Additionally, custom configurations are possible. The website supports many of the features needed to quote and order commercial grade laminate or melamine products. The best value is made available by selecting from the standard features listed below (Default settings in the configurator)

Standard door

None

Standard Sizes

Width ranges 18" to 39"

Height ranges 23 1/2"

Depth ranges 18" to 30"

Standard features

Unfinished Sides – 3/4" white melamine

Finished Sides - 3/4" HPL exterior, white liner interior

Unfinished bottom - 3/4" white melamine

Unfinished top stretchers - 3/4" white melamine

Unfinished back – None

Unfinished shelves - None

Unfinished shelves – None

Doors and Drawer front – 3/4" HPL exterior, white liner interior

Cabinet edgeband - .018 PVC

Door and Drawer front edgeband – .018 PVC or 3mm PVC

Standard Hardware

Hinges – None

Pull – 4" satin chrome wire pull

Shelf Clips – None

Keku clips for removable panel

Standard Options

Finished ends – 3/4" HPL exterior, white liner interior

Custom Options

Sub-Bases – None

Locks – None

Finished Interiors – 3/4" HPL interiors with either white liner exterior or matching HPL exteriors, determined by finished end selection.

Accessory Options

See Accessory list which include Hardware, Components and Operations.