

W2D-MICRO

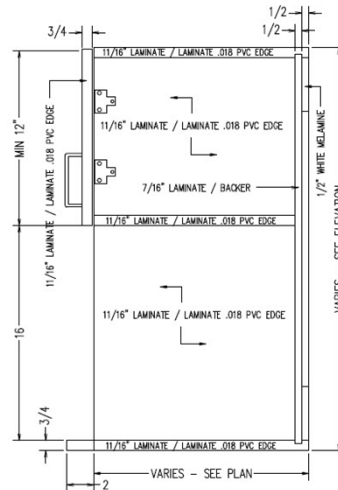

Radius Corner

Double door wall cabinet
with microwave space



TYPICAL WMICRO

(NOTE: NO LIGHT RAIL FOR THIS CABINET)

SCALE: 1-1/2" = 1'-0"

Laminate cabinets are available in a wide range of standard features and options. Additionally, custom configurations are possible. The website supports many of the features needed to quote and order commercial grade laminate or melamine products. The best value is made available by selecting from the standard features listed below (Default settings in the configurator)

Standard door

Hinged in Pairs

Standard Sizes

Width ranges 18" to 42"
Height ranges 12" to 48"
Depth ranges 9" to 24"

Standard features

Unfinished Sides – 3/4" HPL Interior, white liner exterior
Finished Sides - 3/4" HPL exterior, HPL interior
Finished bottom - 3/4" HPL exterior, HPL interior (Radius corner on extended bottom)
Unfinished top - 3/4" HPL Interior, white liner exterior
Unfinished back – 1/2" HPL interior, white liner exterior
Unfinished shelves - 3/4" white melamine (Less than 27" wide)
Unfinished shelves – 1" white melamine (27" and wider)
Doors – 3/4" HPL exterior, white liner interior
Cabinet edgeband - .018 PVC
Door edgeband – .018 PVC or 3mm PVC

Standard Hardware

Hinges – 120 degree Blum Hinge
Pull – 4" satin chrome wire pull
Shelf Clips – 5mm metal spoon

Standard Options

Finished ends – 3/4" HPL exterior, HPL interior
Light Rails – Light rails are not recommended for this cabinet

Custom Options

Hang rails – 3/4" plywood "French Cleats". Wall cleat shipped loose for field installation.
Locks – Choice of lock and key options

Accessory Options

Finished Interiors are standard because of the exposed open area. Please unselect FI if white melamine is desired
See Accessory list which include Hardware, Components and Operations.